

WANDERING THREADS EMBROIDERY



United States Travel Map Embroidery Pattern



Full Size Design

Fits 10-Inch Hoop



For personal use only. Please do not distribute or sell.

Fits 10-Inch Hoop

Reverse Image for Iron-On Transfer

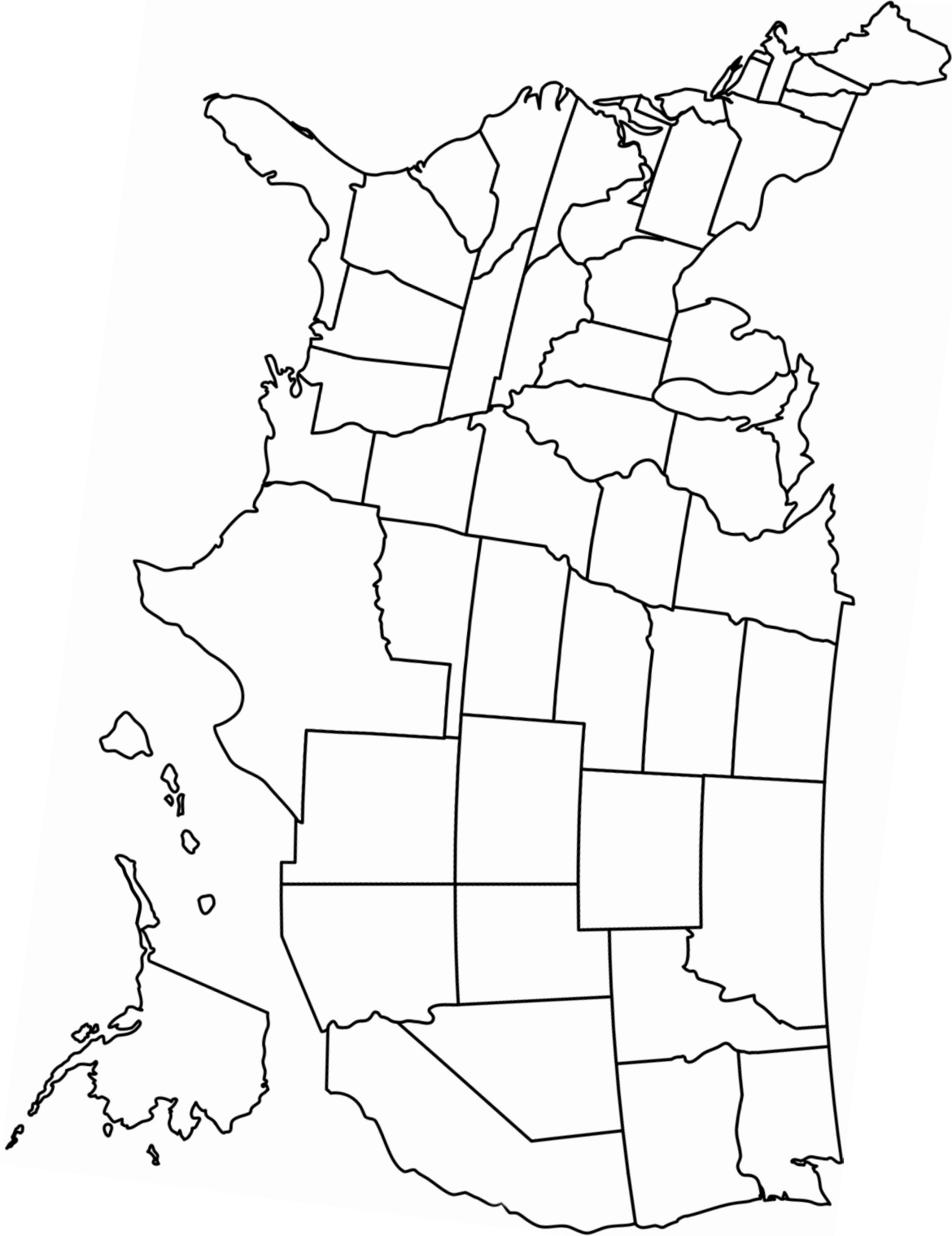

Pattern Transfer

Instructions

Light Table/ Window:

Place the pattern on a light table or tape it to a bright window. Position the fabric on top and secure in place. Trace the pattern onto the fabric using either an ink pen, fine point permanent marker, or water soluble transfer pen. *See transfer notes regarding pen types.

Iron On Transfer Pencil or Pen:

This method uses an iron on transfer pen or pencil which can be found at most fabric/sewing stores. First, print the REVERSE IMAGE pattern. Trace the pattern with the iron on pencil or pen. Place the pattern, traced side down, on top of your fabric. Press a hot iron on top of the fabric for 5-10 seconds. Do not move the iron around. Gently lift an edge of the fabric to check that the design has transferred before removing the fabric. *This method is permanent. See transfer notes below

* Transfer Notes:

If you plan to use the US Travel Map as a road trip memento or to display the states you have visited, the pattern transfer lines need to be permanent. If you plan to fill in the entire map at one time (or over the course of a week or two), a water or air soluble pen will work well and leave behind no pattern marks.

Materials List

- Fabric Square appropriately 12" x 12":
Choose a fabric with a loose to medium weave such as a cotton, muslin, or flour sack. The above example uses a white muslin, but don't be afraid to try a darker color.
- Embroidery Hoop:
Size 10
- Embroidery Needle:
Size 7 or 9
- Ink pen, permanent marker or iron-on transfer pen. (See Transfer Instructions)
- Small Scissors
- DMC Embroidery Floss:
503, 838, 3041, 676,
926, 356

The floss colors are for guidance. Feel free to substitute colors, use more or less colors, or whatever you think looks best. Have fun and make the pattern your own!

Stitch Choice

The stitch recommended for the travel map is **Satin Stitch**. This is a common stitch used for filling shapes. It adds big splashes of color and the end result is a shiny, smooth raised surface that looks like satin.

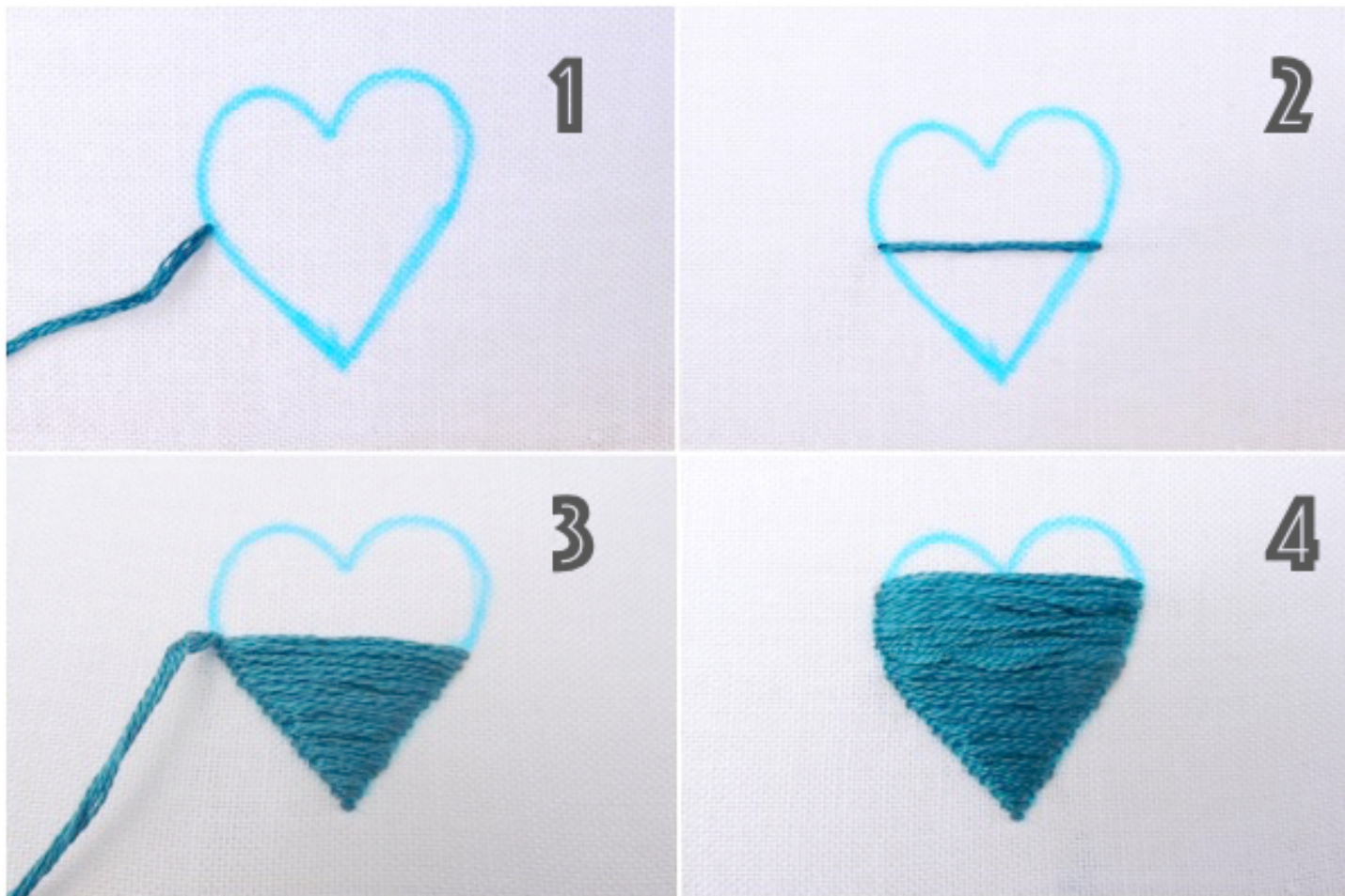

1. Begin by bringing the thread up on one side of the shape. For non-uniform shapes it's easier to start in the middle of the object.
2. Complete the first stitch by crossing the shape and bringing the thread down on the opposite site. Make sure the stitch is straight!
3. Make the second stitch by bringing the needle back up right next to where you started the first stitch. The key to a smooth satin stitch is positioning the stitches close together without overlapping.
4. Continue in this fashion until you reach the bottom of the shape. Now, come back up to where you started and stitch the top half.

For a more complete Satin Stitch tutorial visit:

www.wanderingthreadsewembroidery.com/satin-stitch-embroidery-tutorial

US Map Satin Stitch Tips:

- Keep the stitches straight, parallel and close together while making sure they don't overlap.
- Be careful not to pull the stitches too tight or the fabric will pucker and the shape will become distorted.
- To create more interest, mix up the orientation of the stitch direction on the states next to each other. For example, if the stitches in Colorado are vertical, make the stitches in Utah and Kansas horizontal.
- Always stitch to the outside edge of the drawn line.
- If you're not happy with the edges of your shape (too wobbly), consider outlining it with back stitch. *See below

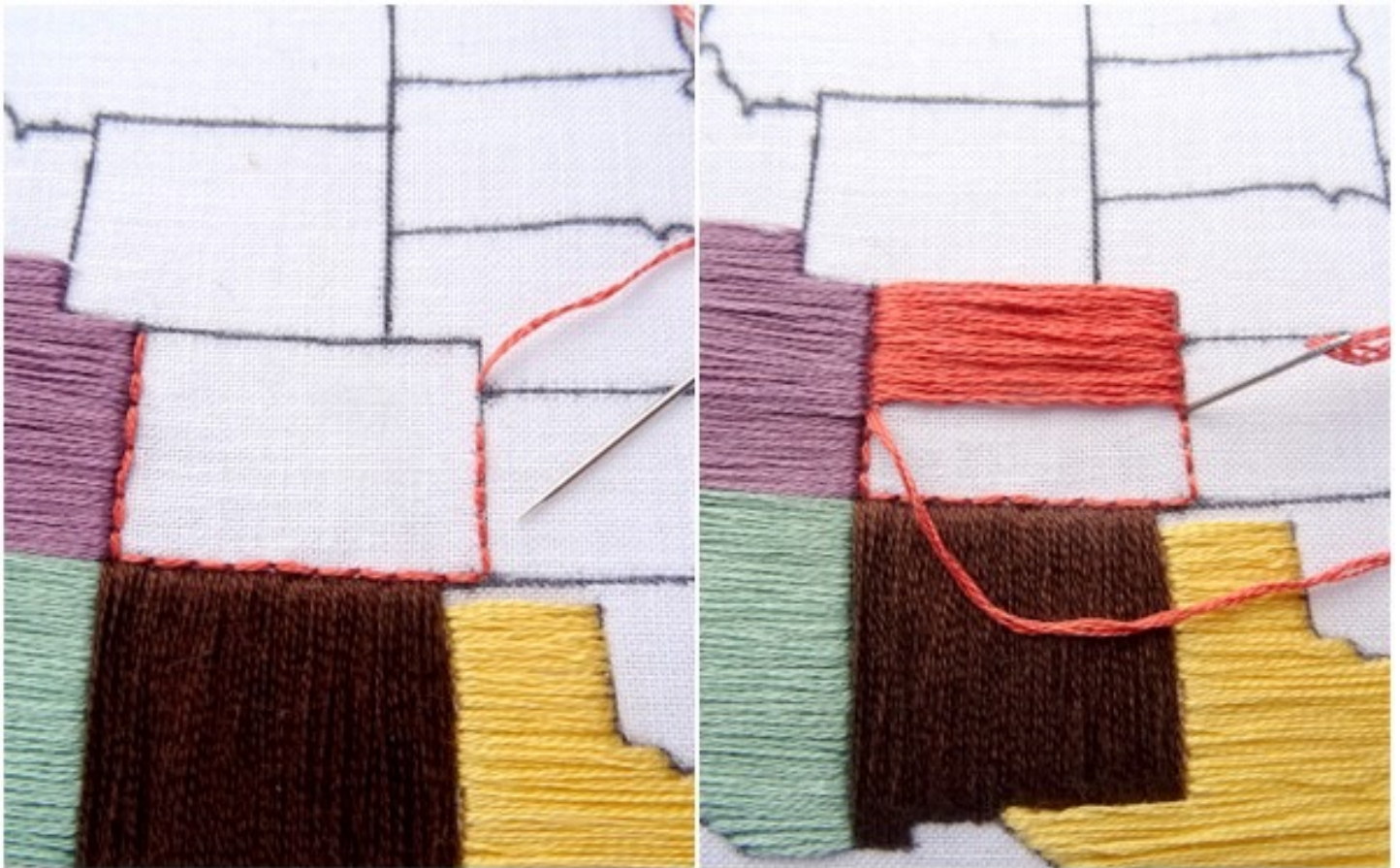

Backstitch Outline Option:

Using backstitch, outline the shape and then stitch over it with satin stitch. This will ensure a neat and even line while slightly raising the edges to make each state stand out. For best results use fewer strands for the outline than the satin stitch (the example uses 2 strands for the outline and 4 strands for the satin).

Love this pattern and want to stitch more?

You are in luck! Visit www.wanderingthreadsembroidery.com to view the full line of downloadable embroidery patterns.

- More Travel Map Patterns Botanical Patterns
- National Park Patterns
- 50 Unique Patterns for Each of the 50 U.S States
- 50 U.S. State Flower Patterns
- The Vintage Trailer Pattern Collection
- City Skyline Patterns
- Botanical Patterns

In addition to patterns, you will also find a full line of embroidery resources to teach and inspire:

- Step-by-Step Embroidery Stitch Tutorials
- FREE Patterns!
- How-To Tutorials Including Framing, Finishing, Embroidery Letters, and More!

Questions or comments? Send me an email at:
amanda@wanderingthreadsembroidery.com

I would love to see your finished pieces! You can find me on Instagram at www.instagram.com/wanderingthreadsembroidery or on Facebook at www.facebook.com/wanderingthreadsembroidery.

Thanks so much for purchasing the United States Travel Map Pattern and happy stitching!

~Amanda